

- Lead Carbon battery
- Constant Current Discharge Characteristics :A(25It's a new technology)
- Fully certified
- More cycles, 200 Cycles at 80% DOD
- Longer life time
- It is more suitable for application of PSOC
- Smart power grid and micro-grid system
- Distributed energy storage system
- Solar and wind energy storage system
- Solar power generation grid or off-grid energy storage system
- Generation and battery hybrid energy storage system
- storage system



SPECIFICATION

| | |
|------------------------------------|---|
| Cells Per Unit | 6 |
| Voltage Per Unit | 12 |
| Capacity | 200Ah@20hr-rate to 1.75V per cell @25C |
| Weight | Approx. 62.5 Kg (Tolerance±1.5%) |
| Internal Resistance | Approx. 4.0 mΩ |
| Terminal | F10(M8)/F16(M8) |
| Max. Discharge Current | 2000A (5 sec) |
| Design Life | 15 years |
| Maximum Charging Current | 80.0 A |
| Cycle Use Voltage | 13.8 V~14.0 V @ 25C Temperature Compensation: -4mV/ /Cell |
| Operating Temperature Range | Discharge: -20C~60C ,Charge: 0C~50C ,Storage: -20C~60 |
| Normal Operating Temperature Range | 25 C±5 C |
| Self Discharge | The batteries can be stored for up to 6 months at 25C and then recharging is recommended. Monthly Self-discharge ratio is less than 4% at 25c. Please charged batteries before using. |

Constant Current Discharge Characteristics :A(25c)

| F.V/Time | 1HR | 2HR | 3HR | 4HR | 5HR | 8HR | 10HR | 20HR | 48HR | 72HR | 100HR | 120HR |
|----------|-------|------|------|------|------|------|------|------|------|------|-------|-------|
| 1.60V | 110.9 | 65.0 | 48.4 | 38.3 | 32.3 | 22.0 | 19.3 | 10.4 | 4.47 | 3.06 | 2.25 | 1.92 |
| 1.65V | 108.8 | 63.9 | 47.6 | 37.8 | 31.9 | 21.8 | 19.1 | 10.3 | 4.42 | 3.03 | 2.23 | 1.90 |
| 1.70V | 106.1 | 62.4 | 46.6 | 37.1 | 31.3 | 21.5 | 18.9 | 10.2 | 4.36 | 2.99 | 2.20 | 1.87 |
| 1.75V | 102.3 | 60.4 | 45.3 | 36.1 | 30.6 | 21.0 | 18.5 | 10.0 | 4.28 | 2.93 | 2.16 | 1.84 |
| 1.80V | 97.0 | 57.6 | 43.4 | 34.8 | 29.6 | 20.4 | 18.0 | 9.73 | 4.16 | 2.85 | 2.10 | 1.79 |
| 1.85V | 89.6 | 53.6 | 40.7 | 32.8 | 28.1 | 19.4 | 17.3 | 9.33 | 3.99 | 2.74 | 2.01 | 1.71 |

Constant Power Discharge Characteristics :WPC(25c)

| F.V/Time | 1HR | 2HR | 3HR | 4HR | 5HR | 8HR | 10HR | 20HR | 48HR | 72HR | 100HR | 120HR |
|----------|-------|-------|------|------|------|------|------|------|------|------|-------|-------|
| 1.60V | 207.4 | 123.1 | 92.4 | 73.5 | 62.2 | 43.0 | 38.0 | 20.5 | 8.78 | 6.01 | 4.42 | 3.77 |
| 1.65V | 205.6 | 121.9 | 91.5 | 72.9 | 61.8 | 42.7 | 37.7 | 20.4 | 8.71 | 5.97 | 4.39 | 3.74 |
| 1.70V | 201.1 | 119.5 | 89.8 | 71.7 | 60.8 | 42.1 | 37.2 | 20.1 | 8.60 | 5.89 | 4.33 | 3.69 |
| 1.75V | 194.9 | 116.2 | 87.6 | 70.1 | 59.6 | 41.3 | 36.5 | 19.7 | 8.45 | 5.78 | 4.26 | 3.62 |
| 1.80V | 185.8 | 111.4 | 84.3 | 67.7 | 57.8 | 40.1 | 35.6 | 19.2 | 8.23 | 5.63 | 4.14 | 3.53 |
| 1.85V | 172.8 | 104.3 | 79.4 | 64.2 | 55.1 | 38.4 | 34.2 | 18.5 | 7.91 | 5.41 | 3.98 | 3.39 |

Dimensions

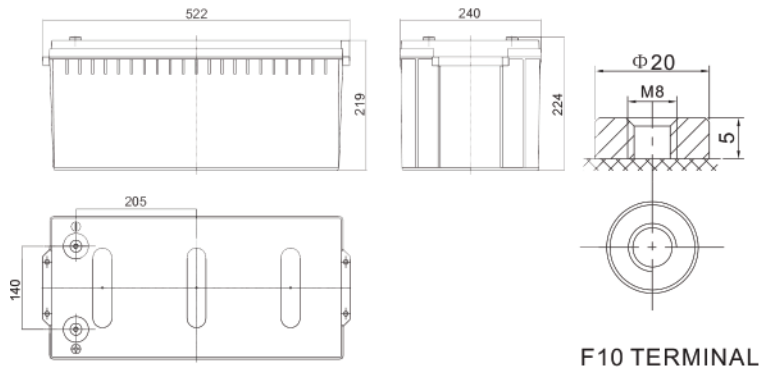

Unit: mm

| Length | 522±2mm (20.6 inches) |
|--------------|-----------------------|
| Width | 240±2mm (9.45 inches) |
| Height | 219±2mm (8.62 inches) |
| Total Height | 224±2mm (8.82 inches) |
| Terminal | Value |
| M5 | 6~7 N*m |
| M6 | 8~10 N*m |
| M8 | 10~12 N*m |

Reference Capacity

| Hour Rate | C20 (Ah) | C72 (Ah) | C100 (Ah) | C120 (Ah) |
|---------------|----------|----------|-----------|-----------|
| F.V (V/Cell) | 1.75 | 1.85 | 1.85 | 1.85 |
| Capacity (Ah) | 200.0 | 197.3 | 201.0 | 205.2 |

Characteristic Curve

